

- ECONOMY INDUCTOR SERIES SUITABLE FOR SMPS AND RF APPLICATIONS.
- EXCELLENT PERFORMANCE IN A SMALL PACKAGE.
- LOW ABOVE BOARD HEIGHT (.185"/4.7mm MAXIMUM).
- WIDE RANGE OF INDUCTANCE VALUES 10 $\mu$ H - 220 $\mu$ H AND HIGH CURRENT RATINGS 350mA - 1.44ADC.

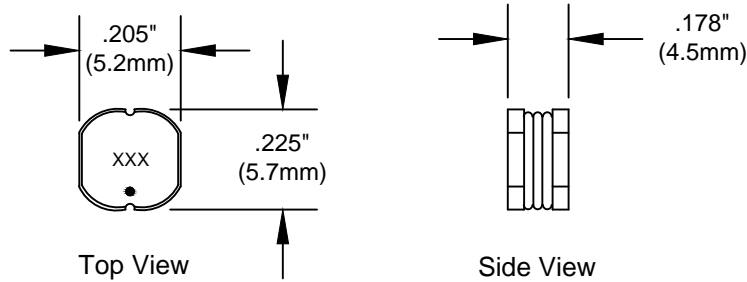

Tolerance :  $\pm 0.2$ mm unless otherwise specified.

"•" On top of Core Identifies Start

XXX = ID# to correspond with the Inductance Value in Microhenries.

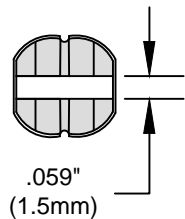

Bottom View

REVISIONS

DATE	REV	DESCRIPTION	APPV'D
04/26/02	-1	corrected tolerance, chg'd dim tol. to ref.	G.G.
09/27/02	-2	chg'd ele.specs. & dim. to meet alt. source	G.G.
10/26/15	-3	Deleted color dot option	Tjk

Electrical Parameters

ID#	Max Dcr	L	Idc Max
100	0.100 $\Omega$	10.0 $\mu$ H $\pm 20\%$	1.44 A
150	0.140 $\Omega$	15.0 $\mu$ H $\pm 20\%$	1.30 A
220	0.180 $\Omega$	22.0 $\mu$ H $\pm 20\%$	1.11 A
330	0.230 $\Omega$	33.0 $\mu$ H $\pm 15\%$	0.88 A
390	0.320 $\Omega$	39.0 $\mu$ H $\pm 15\%$	0.80 A
470	0.370 $\Omega$	47.0 $\mu$ H $\pm 15\%$	0.72 A
560	0.420 $\Omega$	56.0 $\mu$ H $\pm 10\%$	0.68 A
680	0.460 $\Omega$	68.0 $\mu$ H $\pm 10\%$	0.61 A
820	0.600 $\Omega$	82.0 $\mu$ H $\pm 10\%$	0.58 A
101	0.700 $\Omega$	100.0 $\mu$ H $\pm 10\%$	0.52 A
151	1.100 $\Omega$	150.0 $\mu$ H $\pm 10\%$	0.40 A
181	1.380 $\Omega$	180.0 $\mu$ H $\pm 10\%$	0.38 A
221	1.570 $\Omega$	220.0 $\mu$ H $\pm 10\%$	0.35 A



CUSTOM ENGINEERING MAGNETIC COMPONENTS  
 Johnsburg, Illinois  
 3521 N. Chapel Hill Rd. / McHenry, Illinois 60051

SCALE: None

APPROVED BY:

DRAWN BY Tjk

DATE: 11-08-01

*Theodore J Klotz*

REVISED

Mechanical - Electrical for Surface Mount SMI-1 Inductor

DRAWING NUMBER  
**SMI-1 -3**